

<p>OWNER TASMANIAN LAND CONSERVANCY INC</p> <p>FOLIO REFERENCE CT 102690-4</p> <p>GRANTEE 2722 2723 PART OF LOTS 2721 & 2722, 923AC GTD TO JOHN DEGRAVES AND CHARLES DEGRAVES</p>	<p>PLAN OF SURVEY</p> <p>BY SURVEYOR A. S. HAMILTON</p> <p>LOCATION LAND DISTRICT OF MONMOUTH PARISHES OF PELHAM AND GRAFTON</p> <p>SCALE 1 7500 LENGTHS IN METRES</p>	<p>REGISTERED NUMBER SP166563</p> <p>APPROVED 11 NOV 2013 EFFECTIVE FROM</p> <p><i>Alice Kawa</i> Recorder of Titles</p>	
<p>MAPSHEET MUNICIPAL CODE No. 105 (4828)</p>	<p>LAST UPI No. 2001977</p>	<p>LAST PLAN No. SP 152912</p>	<p>ALL EXISTING SURVEY NUMBERS TO BE CROSS REFERENCED ON THIS PLAN</p>

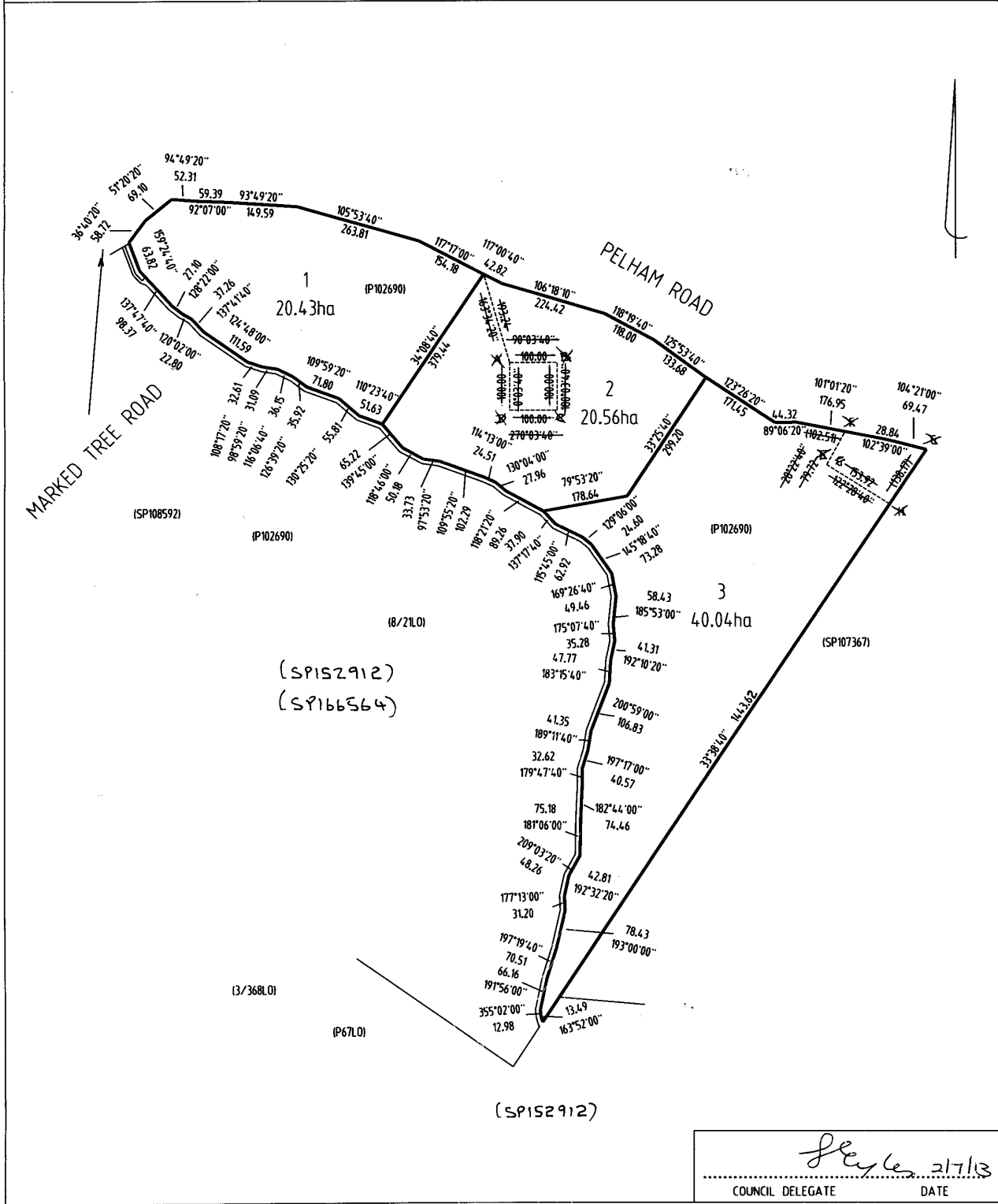

Jeyles 21/13
COUNCIL DELEGATE DATE